

 **Bambi**
BUCKET®



BAMBI BUCKET



Photo: Casey Christie

THE LEGENDARY BAMBI BUCKET

SEI Industries Ltd. first introduced the original Bambi Bucket® to the firefighting community in 1982. This lightweight, strong, flexible firefighting bucket, with its relatively low-cost 'plug-n-play' became the world's first, fully collapsible aerial firefighting bucket. By combining the Bambi Bucket with SEI's already-existing water storage tanks and bladder bladder products (FireFlex) for fire suppression, a sought after and valuable product line was created

INDUSTRY STANDARD

Today, more than 35 years later, SEI services 95% of the world's aerial firefighting water bucket market. Globally, the Bambi Bucket brand is known amongst firefighting agencies and Bambi Buc has become synonymous with aerial firefighting. The legendary Bambi Bucket is now used in more than 120 countries around the world by more than 1,000 helicopter operators.



- simple technology
- fully collapsible and lightweight
- single, full salvo drop
- foam/gel/retardant compatible
- available with PowerFill option

BAMBI MAX



SAFETY AND ACCURACY IN THE PALM OF YOUR HAND.

"With more than 8,000 hours and more than 25 wildfire seasons I consider the Bambi Max the best product for the fight against wildfires."

In the process of innovation, Bambi Max provides safety and effectiveness when working on wildfires."

-Agustin Baigorri
CHIEF PILOT
COYOTAIR,
SPAIN



Bambi *MAX*

- manual time on trigger or automatic Bambi Master Controller.
- unlimited load shedding.
- low power draw, 3-wire system
- low maintenance
- available with PowerFill, Sacksafoam, and Bambi Master Controller.



POWERFILL



PowerFill Snorkel

Bambi PowerFill snorkel is one of the most sought after add-on accessories for the Bambi Bucket product line. Now with a quick-release connection, you can take it on and off within seconds.

PowerFill technology allows users to fill their Bambi Buckets in shallow water sources where dry summer conditions limit dip site possibilities. Only 18 inches (46 cm) of water is required to pull water from the bottom up.



PowerFill **MAX**

The Bambi Max also comes with a 2-pump or 4-pump internal configuration. This bottom filling technology provides fill rates of 900 to 1800 US gallons per minute. Retrofit kits available to convert your Bambi Max to PowerFill Max.

Contact one of our reps for more information.

1-866-43-BAMBI

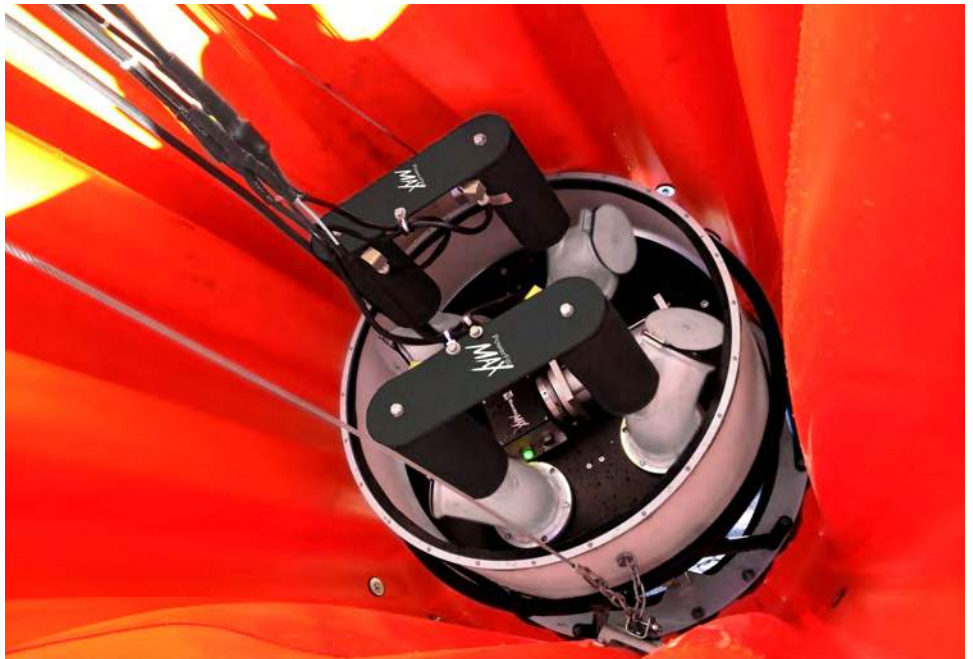

BAMBI MASTER CONTROLLER (BMC)

- 5.7" 640x480 LCD with resistive touch screen user interface
- cockpit installed, pilot or crew operated
- pre-select bucket functionality during pre-flight or change on the fly
- intuitive logic, highly visible, user-friendly, touch screen display
- one controller actuates bucket valve, dispenses foam, activates Powerfill™ pumps
- allows for automatic load shedding via preselect volume control
- enables partial valve openings to extend drop (coverage level control)
- download data from controller memory and export to Excel or flight following software

* compatible with Bambi Max buckets only

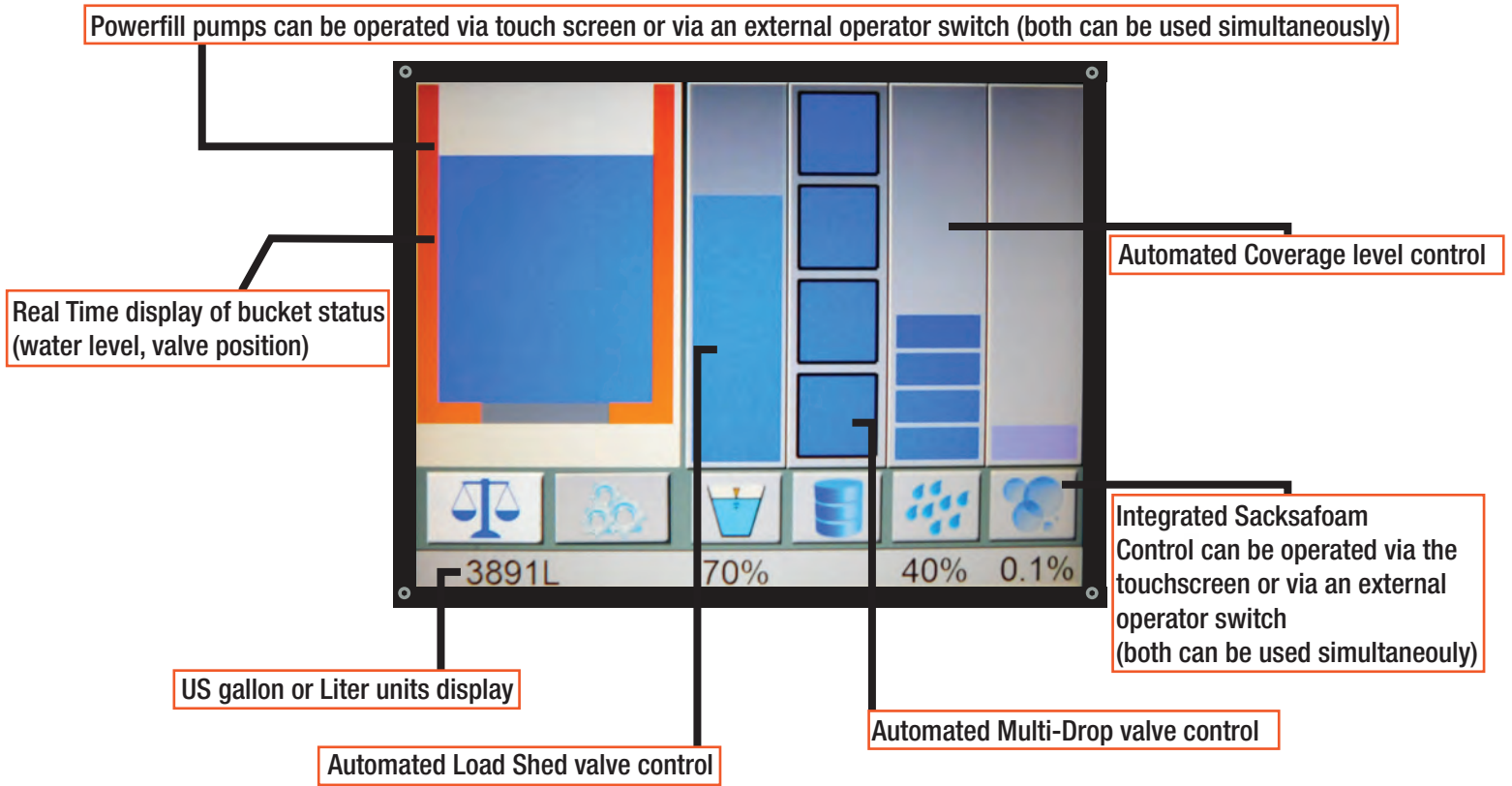

Sacksafoam Bladder (SF1)

The Sacksafoam Bladder is designed to be easily installed inside all Bambi Buckets. The built-in pump allows for accurate foam distribution, avoiding foam waste, and creating more foam-filled drops.



Sacksafoam Heli-Case (SFX)

The SFX is designed to be installed and strapped down inside helicopters to supply foam concentrate through a line attached to the bucket. The Heli-Case gives more control to the pilot or crew on board, allowing each load to be filled precisely with foam. The SFX will hold up to 25 USG (95 Litres) of foam concentrate. Compatible with bucket models 2024-HL5000

*Sacksafoam Plus available for additional foam concentrate
40 USG/151 Liter*



POWER PACK/MOBILITY SLED



CALL FOR INFO ON BAMBI LONGLINES
North America: 1.866.570.3473
International: 1.866.43 BAMBI

Bambi PowerPack™

A portable, rechargeable power supply used with Bambi Bucket and Bambi MAX that allows for 10 hours of continuous operation on a fuel charge. Bambi PowerPack works independently of the helicopter power supply. Recharge to 100% in 2-hours.



Mobility Sled™

Convenient one person operation with a rugged lightweight design. Four-wheeled aluminium mobility sled comes equipped with 16" foam filled, all-terrain tires, tow bar and a braking system. Can be quickly dismantled for shipping. Roll, winch and go!



SPECIFICATIONS & COMPATIBILITY

	CAPACITY			EMPTY WEIGHT		GROSS WEIGHT		OVERALL LENGTH*		Firesock	Power Pack	PowerFill Snorkel	PowerFill Max	Sacksafoam Bladder	Sacksafoam Heli-Case	Sacksafoam Plus
	USG	liters	lbs	kg	lbs	kg	fts	cm								
BAMBI BUCKET	BB 6072	72	270	70	32	670	300	12'11"	394							
	BB 8096	96	360	73	33	870	390	14'6"	442							
	BB 9011	108	410	74	34	970	440	14'6"	442							
	BB 1012	120	450	74	33	1070	490	14'6"	442							
	BB 1214	144	550	75	34	1280	580	14'10"	452							
	BB 1518	180	680	79	36	1580	720	15'2"	462							
	BB 1821	216	820	88	40	1890	860	15'11"	470							
	BB 2024	240	910	130	59	2130	970	20'1"	592							
	BB 2226	260	1000	128	58	2330	1060	15'10"	470							
	BB 2732	320	1230	137	62	2840	1290	23'0"	701							
	BB 3542	420	1590	145	66	3650	1650	23'8"	714							
	BB 4453	530	2000	180	80	4580	2080	23'8"	721							
	BB 5566	660	2500	260	120	5760	2610	24'7"	749							
	BB 6578	780	2950	310	140	6810	3090	25'1"	763							
	BB 7590	900	3410	340	150	7840	3550	30'6"	930							
	BBHL 4000	1060	4000	360	160	9160	4150	31'8"	965							
	BBHL 5000	1320	5000	390	180	11390	5170	32'0"	975							
	BBHL 7600	2010	7600	470	210	17190	7800	33'1"	1008							
BBHL 9800	2590	9800	530	240	22090	10020	34'3"	1044								
BAMBI MAX	BBX 1518	180	680	95	43	1600	720	13'5"	408							
	BBX 1821	216	820	105	48	1900	860	13'7"	414							
	BBX 2024	240	910	140	63	2140	970	16'7"	505							
	BBX 2226	260	1000	138	63	2340	1060	13'0"	396							
	BBX 2732	320	1230	148	67	2850	1290	19'11"	607							
	BBX 3542	420	1590	155	70	3660	1660	20'9"	632							
	BBX 4453	530	2000	230	100	4630	2100	23'8"	721							
	BBX 5566	660	2500	300	140	5800	2630	24'7"	749							
	BBX 6578	780	2950	340	150	6840	3100	25'1"	763							
	BBX 7590	900	3410	370	170	7870	3570	30'6"	930							
	BBXHL 4000	1060	4000	380	170	9180	4160	31'8"	965							
	BBXHL 5000	1320	5000	400	180	11400	5170	32'0"	975							
BBXHL 7600	2010	7600	490	220	17210	7800	33'1"	1008								
BBXHL 9800	2590	9800	550	250	22110	10030	34'3"	1044								

*Bambi BBT 4453 | 5566 | 6578 discontinued
Please contact SEI Industries for more information.

Specifications are subject to change without notice
Weights listed above do not account for accessories



SEI INDUSTRIES LTD
7400 Wilson Avenue
Delta, British Columbia
Canada V4G 1H3

International: 1.866.43. BAMI
Canadian Tel: 1.604.946.3131
E-mail: sales@sei-ind.com
WWW.BAMBI-BUCKET.COM